

TONGAROA



TONGAROA is a very well maintained and extensively upgraded example of the highly regarded Leopard 44 cruising catamaran from Robertson & Caine. Designed by Morelli & Melvin, the Leopard 44 combines excellent offshore capability with spacious accommodation and the highly desirable forward cockpit arrangement that made the model one of the most successful cruising catamarans of her generation. This particular example has benefitted from continuous upgrades and careful ownership, including a substantial refit and modernisation program between 2020 and 2026. She is Spanish Lista 6^a charter compliant and her inventory is exceptionally comprehensive — large lithium capacity, 1500W of solar, air conditioning, Starlink, upgraded Raymarine electronics and a Highfield tender with electric outboard.

NOTABLE FEATURES

- Extensive upgrades and modernisation program completed between 2020–2026
- 1500W solar array with custom stainless steel structure
- 840Ah LiFePO4 lithium battery bank installed in 2023
- Upgraded Raymarine navigation suite with Axiom chartplotter
- Rebuilt sail drives with new seals and bearings in 2026
- New standing rigging in 2021, inspected and tuned in 2025
- New running rigging in 2025
- Full custom Sunbrella cockpit enclosure
- Air conditioning throughout
- Spanish Lista 6^a charter compliant
- Highfield tender with Torqeedo electric outboard
- Starlink onboard

GENERAL

Price	€ 350,000 ex. VAT
Location	Barcelona, Spain
Year Built	2013
Flag	Spanish Lista 6 ^a
Builder	Robertson & Caine
Designer	Morelli & Melvin
LOA	12.98 metres
Beam	7.25 metres
Draft	1.27 metres
Fuel	700 litres (2 × 350L)
Water	1,000 litres (2×450 + 100)



DESIGN & CONSTRUCTION

- Built by Robertson & Caine in 2012, delivered 2013
- Designed by Morelli & Melvin
- Solid fibreglass hull and deck construction, no foam core
- Forward and aft cockpit arrangement
- Hardtop bimini over cockpit
- Large outdoor entertaining areas
- Excellent visibility and ventilation throughout
- Custom dark grey hull stripes fitted in 2022
- Custom black mesh side window covers fitted in 2022
- Custom Sunbrella captain's enclosure fitted in 2021
- Custom rear cockpit curtains fitted in 2022
- Custom exterior cushions fitted in 2023
- Swimming ladder
- Sprayhood
- Eight fenders with covers

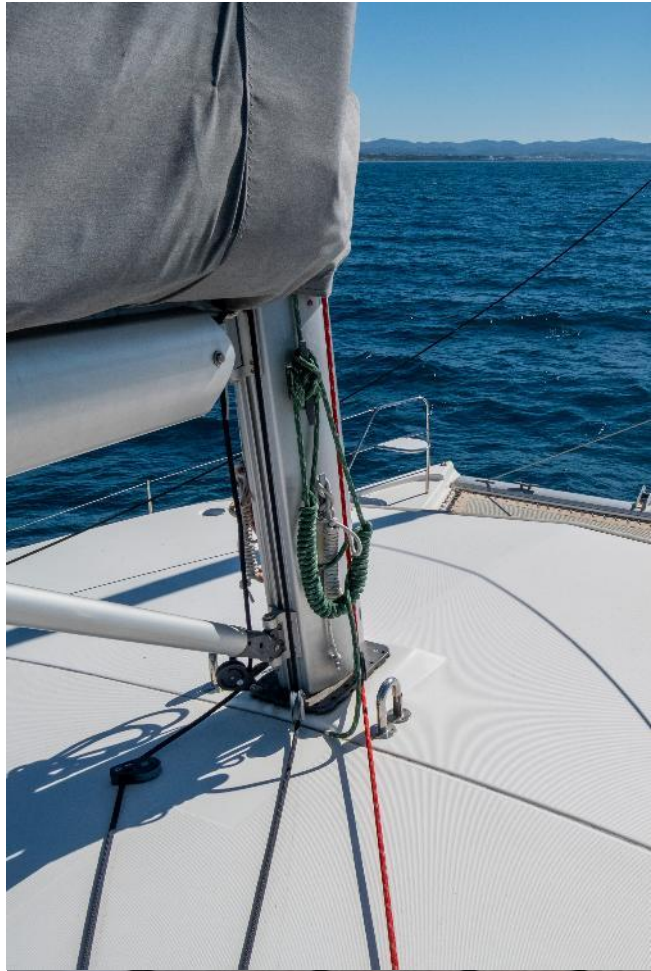







RIG & SAILS

- Fractional sloop rig
 - New standing rigging fitted in 2021
 - New running rigging fitted in 2025
 - Professionally inspected and tuned in 2025
 - Fully battened mainsail – 76m² with two reefs
 - 120% furling genoa – 47m²
 - Spare mainsail
 - Spare genoa
 - Sunbrella sail bag fitted in 2022
- Lewmar 45 two-speed self-tailing manual sheet winch
 - Lewmar 45 two-speed self-tailing electric halyard winch
 - Highfield 290 tender
 - Torqeedo 5HP electric outboard







INTERIOR & ACCOMMODATION

- Four double cabins with four full heads with showers
- Additional bow berths
- Excellent natural light and airflow throughout
- New interior dining table fitted in 2022
- New interior couch cushions fitted in 2022
- Air conditioning throughout saloon and cabins
- Two ventilation fans in saloon
- Four ventilation fans in cabins

GALLEY

- Force 10 three-burner gas stove and oven
- Vitrefrigo refrigerator/deep freezer (compressor replaced 2020)
- Twin stainless steel sinks
- Breadmaker
- Nespresso machine
- Professional panini maker







SYSTEMS

PROPULSION

2 × Yanmar 3JH5E, 39HP diesel engines
2 × 350L aluminium diesel tanks
Approx. 3,500 engine hours each
Major overhaul completed between 2021–2026

New water pumps in 2026
New galvanic isolator fitted in 2020
New bottom paint completed April 2026

ELECTRICAL

12V / 220V electrical system
3 × LiFePO4 lithium batteries with individual BMS, totalling 840Ah (fitted 2022)
2 × AGM engine start batteries
AGM generator battery
Emergency AGM VHF battery with charger

6 rigid solar panels totalling 1500W on custom stainless structure (2021)
Victron SmartSolar charge controllers (2021)
Victron 220V charger and 3000W pure sine inverter (2021)
Two alternators
Two shore power cables

Northern Lights 6kW generator, approx. 2,830 hours, major service 2025
All LED navigation lights replaced in 2020

WATER

3.5 GPM freshwater pressure pump with 1L accumulator and extra filter
2 × 450L LLDPE water tanks
1 × 100L LLDPE water tank

Two Quick Nautic water boilers — hot and cold pressurised water throughout
Exterior cockpit shower

Air conditioning throughout saloon and cabins

INVENTORY

NAVIGATION & COMMUNICATION

Extensively upgraded Raymarine navigation suite
Raymarine Axiom chartplotter
Raymarine LCD displays fitted in 2020
Raymarine autopilot fitted in 2020
Raymarine VHF radio fitted in 2020
External Raymarine VHF speaker
Raymarine depth transducer fitted in 2020
Em-trak B954 AIS transceiver fitted in 2025
Plastimo compass

Starlink satellite internet

Entertainment: JVC stereo with CD and Bluetooth
Two speakers in saloon
Two marine cockpit speakers aft, two forward

GROUND TACKLE & MOORING

Cockpit anchor controller fitted in 2021
Quick 1000W horizontal windlass with handheld remote
Primary 25kg Delta anchor with 90m chain
Secondary 16kg Kedge anchor with 8m chain
Anchor bridle, shackles and hook
Eight fenders with covers

COVERS & CUSHIONS

Custom Sunbrella captain's enclosure fitted in 2021
Full custom Sunbrella cockpit enclosure
Custom rear cockpit curtains fitted in 2022
Custom exterior cushions fitted in 2023
Custom black mesh side window covers fitted in 2022
Sunbrella sail bag fitted in 2022
Sprayhood

Sundry

Breadmaker
Nespresso machine
Professional panini maker
Swimming ladder

SAFETY

Plastimo hardshell 10-person liferaft
JTRON 60 GPS and AIS EPIRB in housing with hydrostatic release (2025)
12 life jackets and harnesses
Five fire extinguishers
Flare kit, first aid kit, tool kit
Engine maintenance kit
Flashlight and air horn
Bung plugs kit
Binoculars
Various charts and sailing guides

TENDER

Highfield 290 tender
Torqeedo 5HP electric outboard



LAYOUT – Leopard 44

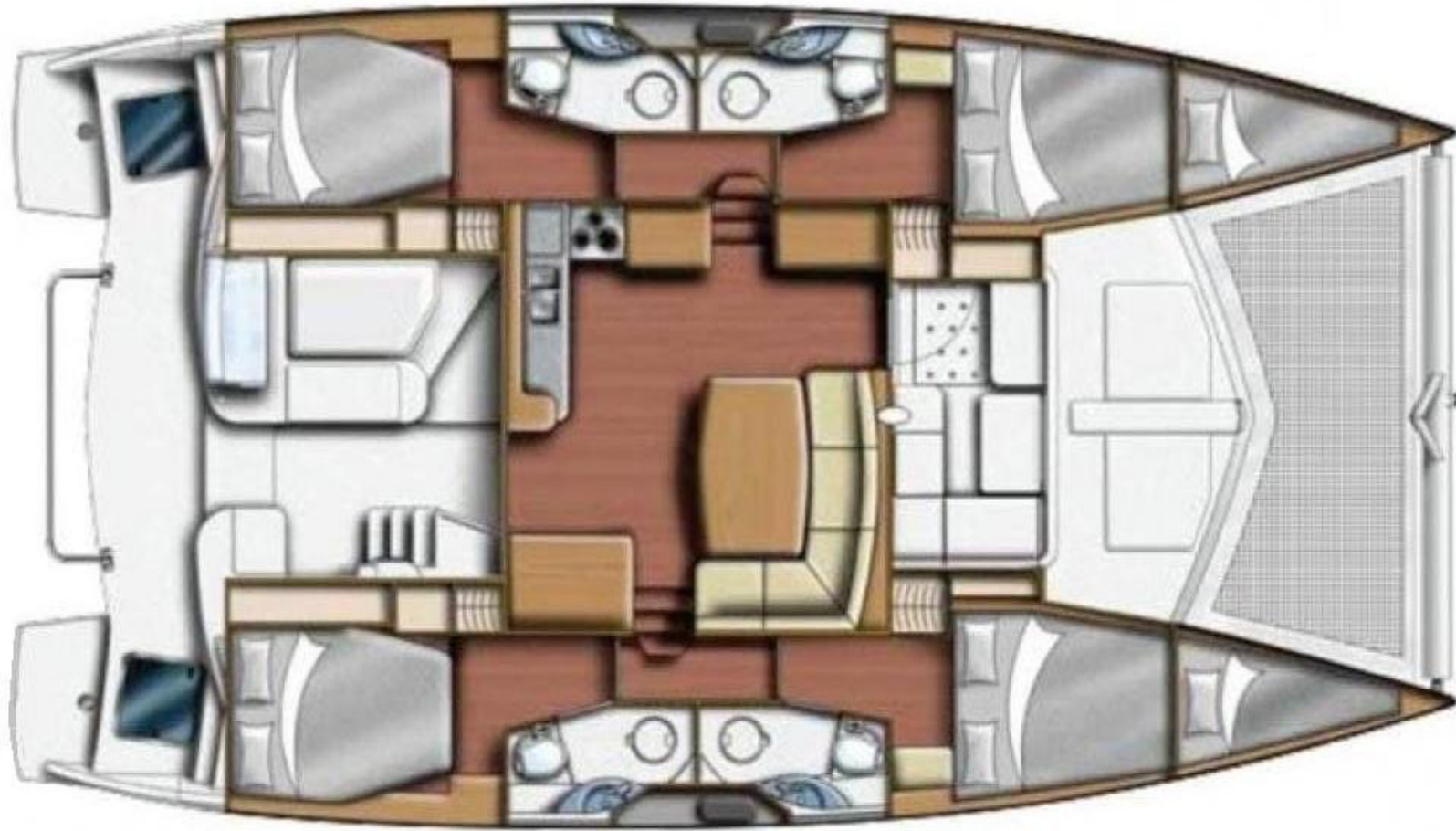

Liam Shannon

E. liam@aberyyachts.com

M . +34 617 621 384



We are acting as brokers for the owner of the Vessel. The owner has provided details of the Vessel and its inventory and these details are based on that information. The accuracy of these details cannot be guaranteed nor do they constitute part of any contract. A prospective buyer is strongly advised to have the Vessel fully surveyed by a qualified marine surveyor and to verify the particulars prior to the survey. The vessel is being sold in the course of a business, which may present potential VAT advantages depending on the purchaser's structure and intended use. This Vessel is offered subject to prior sale, price change or withdrawal without notice.